

## Lenti-X™ GoStix™ Protocol-At-A-Glance (PT5185-2)

Lenti-X GoStix are designed to rapidly confirm the presence of lentivirus, using only 20 µl of packaging cell supernatants. The test detects lentiviral p24 and can be used to determine whether virus production is within a usable range or for selecting the best time to harvest your virus. The included p24 control provides confirmation of GoStix test function.

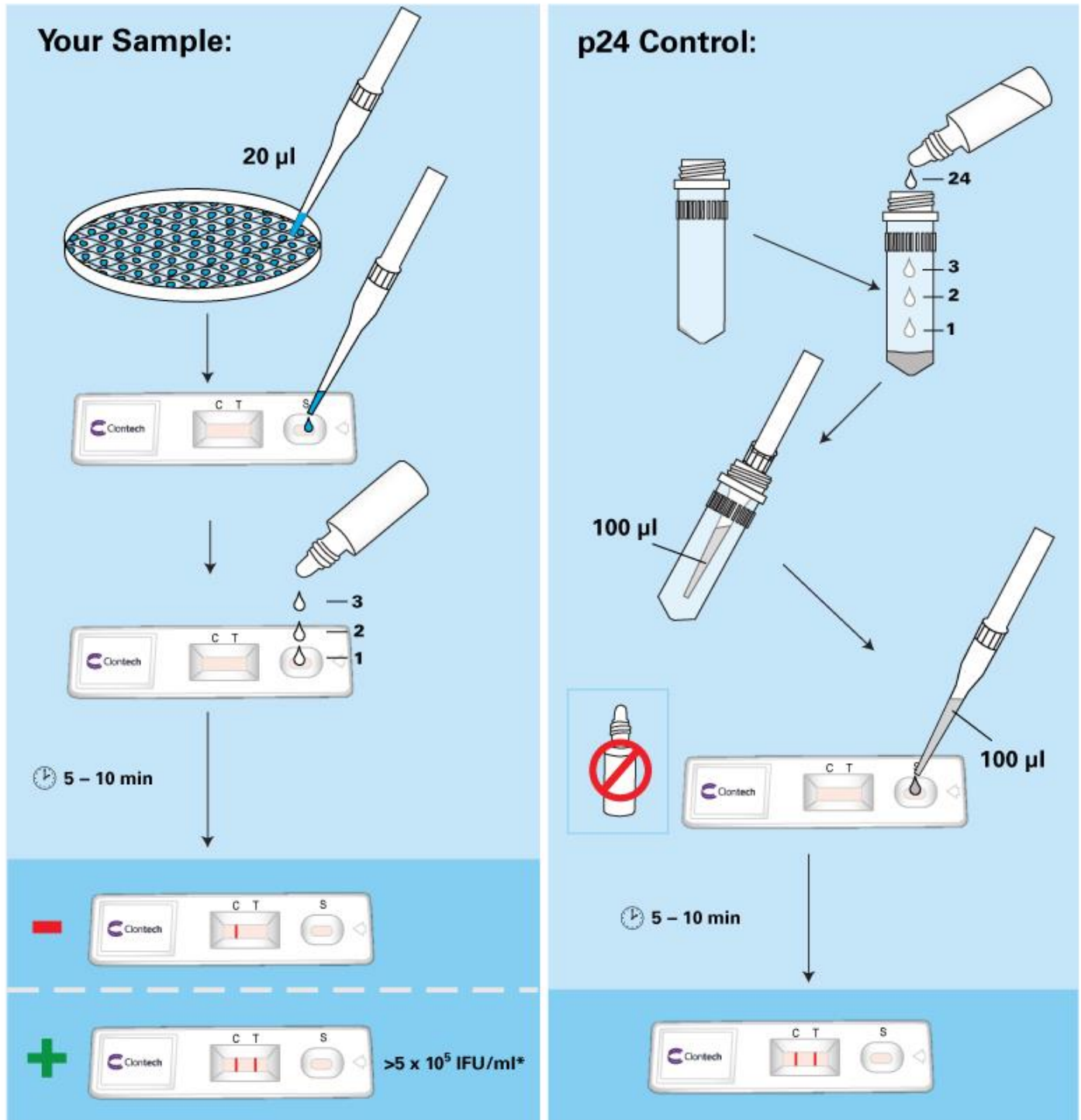

**\*NOTE:** Test sensitivity may vary when compared to different titration methods or when using different lentiviral packaging systems. For example, when Lenti-X GoStix were used to test viral supernatants produced using the Lenti-X HTX Packaging System, Lenti-X 293T Cells, and a pLVX vector expressing Clontech's ZsGreen1 fluorescent protein, a clear band was generated by a diluted supernatant containing >5 x 10<sup>5</sup> IFU/ml (as measured by flow cytometry of transduced HT-1080 cells).

## Your Sample Test

1. Take 20 µl of your lentiviral supernatant and apply to the sample well (S) of the GoStix cassette.
2. Add 3 drops of Chase Buffer to the sample well and wait for the bands to develop.
3. A control band will always appear (C), and a test band (T) will start to appear within 5 min and reach maximum intensity at 10 min if your sample contains sufficient lentivirus.

## p24 Control Test

1. The p24 control is supplied in a dried format. To resuspend add 24 drops of Chase Buffer (~500 µl) and vortex.
2. Apply 100 µl of the p24 control to the sample well (S) of the GoStix cassette.
3. 2 bands (control and test) will appear in 5 min.
4. For additional control tests, add 0.1% sodium azide to the vial and store at 4°C for up to 12 months.

Contact Us	
Customer Service/Ordering	Technical Support
tel: 800.662.2566 (toll-free)	tel: 800.662.2566 (toll-free)
fax: 800.424.1350 (toll-free)	fax: 800.424.1350 (toll-free)
web: <a href="http://www.clontech.com">www.clontech.com</a>	web: <a href="http://www.clontech.com">www.clontech.com</a>
e-mail: <a href="mailto:orders@clontech.com">orders@clontech.com</a>	e-mail: <a href="mailto:tech@clontech.com">tech@clontech.com</a>

## Notice to Purchaser

Clontech® products are to be used for research purposes only. They may not be used for any other purpose, including, but not limited to, use in drugs, *in vitro* diagnostic purposes, therapeutics, or in humans. Clontech products may not be transferred to third parties, resold, modified for resale, or used to manufacture commercial products or to provide a service to third parties without prior written approval of Clontech Laboratories, Inc.

Your use of this product is also subject to compliance with any applicable licensing requirements described on the product's web page at <http://www.clontech.com>. It is your responsibility to review, understand and adhere to any restrictions imposed by such statements.

Clontech, the Clontech logo, GoStix, and Lenti-X are trademarks of Clontech Laboratories, Inc. All other marks are the property of their respective owners. Certain trademarks may not be registered in all jurisdictions. Clontech is a Takara Bio Company. ©2014 Clontech Laboratories, Inc.

This document has been reviewed and approved by the Clontech Quality Assurance Department.